

Carbon Rotary Potentiometers - 16mm size

PC 16 BU Series - single

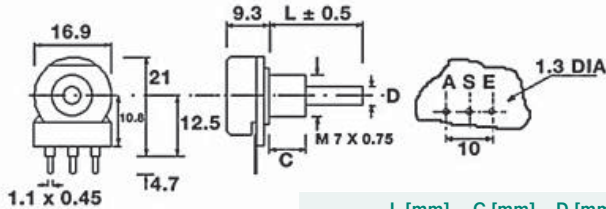

NEW!



	L [mm]	C [mm]	D [mm]
PC16BU	35	6	4

Spindle 4 mm

Technical parameters	PC 16 BU A	PC 16 BU B
Spindle	D=4mm, L=35mm, plastic	
Rotation Angle - mechanical	270°±5°	
Resistance Taper	linear (LIN) A	logarithmic (LOG)B
Power Rating at 40°C	0,25W	0,12W
Tolerance	±20%	
Limiting Element Voltage	350Vdc	
Insulation Voltage	500Vac	
Mounting	PCB pins	
How to order	PC16BU 10K A	PC16BU 10K B

Ohmic Value	LIN	LOG
100R	o 75981	
220R	o 75982	
470R	o 75983	
1K	s 75984	o 75996
2,2K	o 75985	o 75997
4,7K	s 75986	o 75998
10K	s 75987	s 75999
22K	s 75988	o 76000
47K	s 75989	s 76001
100K	s 75990	o 76002
220K	s 75991	o 76003
470K	s 75992	o 76004
1M	o 75993	o 76005
2,2M	s 75994	o 76006
4,7M	o 75995	

POM16 Series - single

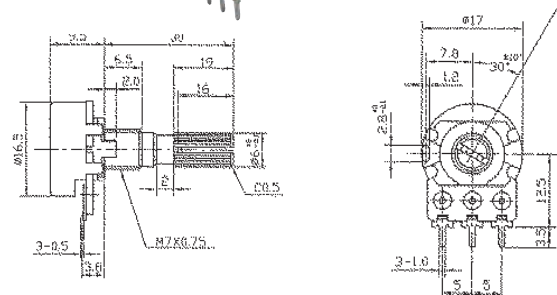

Metal Spindle 6 mm

Technical parameters	POM 16 LIN	POM 16 LOG
Spindle (diameter/length)	6mm/30mm, 18 -teeth, metal	
Rotation Angle - mechanical	300° ± 5°	
Resistance Taper	linear (LIN)B	logarithmic (LOG)A
Power Rating	0,2W	0,1W
Tolerance	±30%	
Insulation Resistance	min. 100 MΩ @ 500Vdc	
Rotational Life	> 15000 cycles	
Operating Temperature	-10°C ...+70°C	
Mounting	PCB pins	
Package	200 pcs	
How to order	POM 16 LIN 10K	POM 16 LOG 10K

Ohmic Value	LIN	LOG
1K	s 53996	s 54004
5K	s 53997	s 54005
10K	s 53998	s 54006
50K	s 53999	s 54007
100K	s 54000	s 54008
200K	s 54001	s 54009
500K	s 54002	s 54010
1M	s 54003	s 54011

POM1620 - single

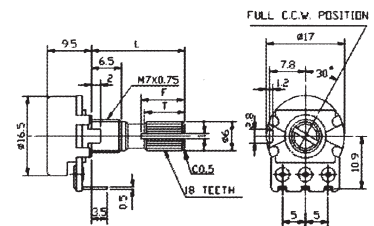
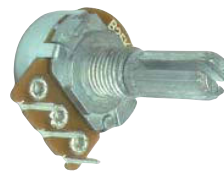

metal Spindle 6 mm

Technical parameters	POM 1620 LIN
Spindle (diameter/length)	6mm/20mm, 18 - teeth, metal
Rotation Angle - mechanical	300° ± 5°
Resistance Taper	linear (LIN)B
Power Rating	0,2W
Tolerance	±30%
Insulation Resistance	min. 100 MΩ @ 500Vdc
Rotational life	> 15000 cycles
Operating Temperature	-10°C ...+70°C
Mounting	PCB pins, horizontal
Package	200 pcs
How to order	POM 1620 LIN

Ohmic Value	LIN
25K	s 61544