

## JV Series

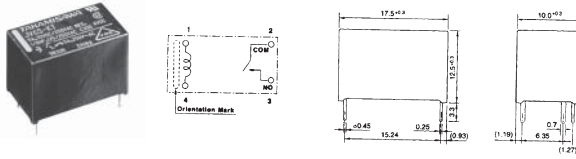

1 POLE-5 A MEDIUM LOAD CONTROL POWER RELAY. UL class B (130°C) insulation, low profile and space saving, high insulation with reinforced insulation system (between coil and contacts)  
S-KT version - SENSITIVE -higher coil resistance- input power only 200mW



Technical Parameters		JV			
Contacts Type		SPST-NO			
Max. Switching Current		5 A			
Max. Switching Voltage		250 VAC / 150 VDC			
Max. Switching Power		1250 VA, 150 W			
Insulating Voltage		5000 VAC			
Operate/Release Time		8 ms / 4 ms			
Temperature Range		-40°C to +70°C			
Mechanical Lifetime		5mil. cycles			
Electrical Lifetime		100 000 cycles			
Dimensions		10 x 18 x 13 mm			

Part No.	Ord. No.	Description	1+	5+	25+
S JV-5S-KT	50845	5V 125R	0,850	0,797	0,724
S JV-12S-KT	8513	12V 720R	0,863	0,810	0,737
S JV-24S-KT	5953	24V 2880R	0,860	0,803	0,734

## Automotive Relays

### FBR 51 Series



1 POLE-30 A COMPACT POWER RELAY. Compact and lightweight structure, high current contact capacity, high resistance to vibration and shock, improved heat resistance and extended operation range

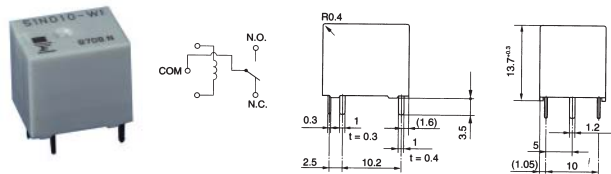

Technical Parameters		FBR 51			
Contacts Type		SPDT			
Max. Switching Current		25 A			
Max. Switching Voltage		14 VDC			
Insulating Voltage		500 VAC			
Operate/Release Time		10 ms / 5 ms			
Temperature Range		-40°C to +85°C			
Mechanical Lifetime		10mil. cycles			
Electrical Lifetime		200 000 cycles			
Dimensions		12,1 x 15,5 x 13,7 mm			

Part No.	Ord. No.	Description	1+	5+	25+
S FBR 51 N D12-W1	6877	12V 240R	0,919	0,860	0,783

### FRA Series

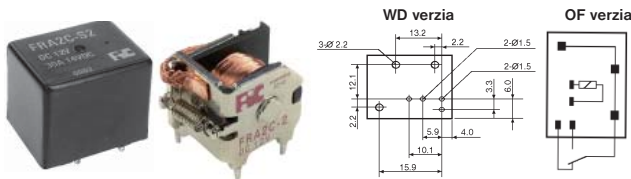

Technical Parameters		FRA			
Contacts Type		SPDT			
Max. Switching Current		30 A			
Max. Switching Voltage		75 VDC			
Insulating Voltage		750 VAC			
Operate/Release Time		5 ms / 3 ms			
Temperature Range		-40°C to +85°C			

Mechanical Lifetime	10mil. cycles
Electrical Lifetime	100 000 cycles
Dimensions	22 x 26,5 x 22,3 mm

Part No.	Ord. No.	Description	1+	5+	25+
S FRA12-OF	47728	12V 90R	1,066	0,996	0,910
S FRA12-WD	5734	12V 90R	1,195	1,119	1,019
S FRA24-WD	6686	24V 362R	1,208	1,132	1,029

## FRC Series

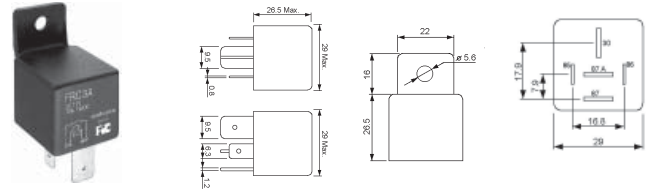

Technical Parameters		FRC			
Contacts Type		SPST-NO			
Max. Switching Current		70 A			
Max. Switching Voltage		75 V			
Insulating voltage		500 VAC			
Operate/Release time		10 ms / 10 ms			
Temperature range		-40°C to +85°C			
Životnosť: mechanická		10mil. cycles			
Electrical lifetime		100 000 cycles			
Dimensions		29 x 33,5 x 26,5 mm			

Part No.	Ord. No.	Description	1+	3+	10+
S FRC3-12F	4249	12V 80R	2,904	2,772	2,566
S FRC3-24F	4309	24V 320R	2,904	2,775	2,569

## SOCKET ZRA-5

Socket for automobile relas PCB mounting.

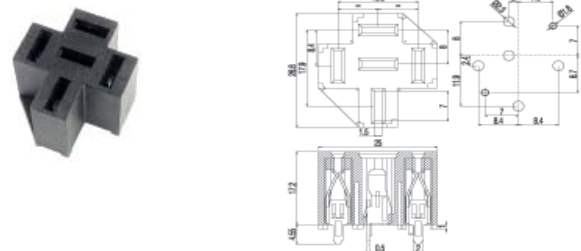

Part No.	Ord. No.	Description	1+	5+	25+
S ZRA-5	50713	16A/250V	0,495	0,461	0,432